

French experience

Modulation of fees

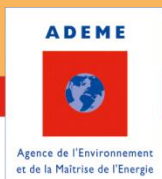

Visible fee: a global financing plan

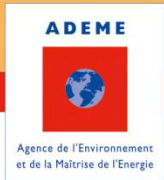

- Mandatory visible fee without possibility of reduction along the chain of intermediates
- Same fee from consumers to logistics and treatment operators (no margin at any step)
- Educational tool
- Guarantee of a long-term financing, in a context of increasing substance regulation and standardization
- Modulation of fee to give incentive to producers

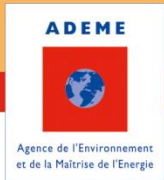

- Mandatory modulation of fees to consider the real end-of-life costs
- 5 EPR are concerned by this modulation of fees (WEEE, Packaging, Paper, Textile and Furniture).
- The set of requirements of PRO states : *the agreement holder proposes to his producer members a contribution scale modulated according to environmental impacts related to the end of live of EEE*
- First set of criteria from 2010 to 2015
 - ➔ 6 products concerned (refrigerating equipment, vacuum cleaners, mobile phones, laptops, televisions, lamp)
- Second set of criteria from 2015 to 2020

Modulation of fees

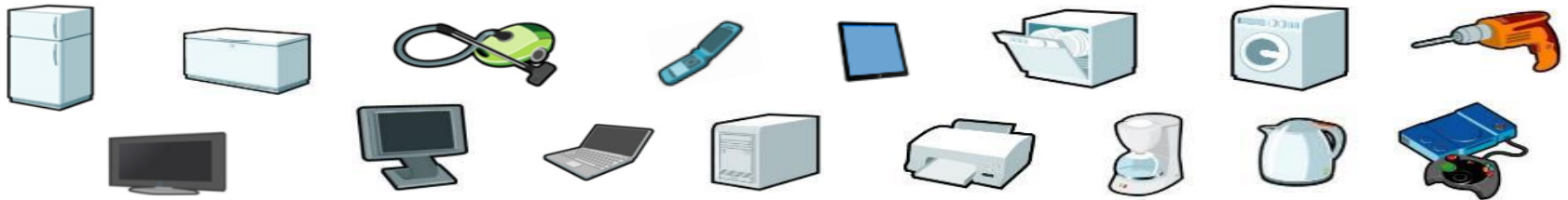

16 kinds of equipment concerned (>50% of overall contributions)

- For each type of equipment, the fees is modulated according to one or several environmental criteria
- Criteria have been mainly inspired on ecolabels :
 - ➔ Availability of technical documentation and spare parts
 - ➔ Possibility to disassemble with standard tools
 - ➔ Standardization of connections and compatibility with software updates
 - ➔ Integration of post-consumer recycled plastics

Example of criteria

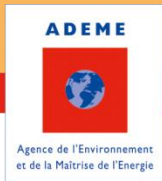

Washing machine	<p>Provision of essential parts for equipment use for 11 years</p> <hr/> <p><u>or</u> Incorporation of post-consumer recycled plastic (minimum threshold of 10%)</p>	<p>- 20 %</p>	<p>If the EEE meets one of the 2 criteria or both, the contribution is reduced by -20%</p>
Vacuum cleaner	<p>Presence of plastic parts > 25 grams containing brominated flame retardants</p> <hr/> <p><u>or</u> Failure to provide technical documentation for electrically authorised repairers</p> <hr/> <p><u>or</u> Unavailability of essential spare parts for equipment use</p>	<p>+ 20 %</p>	<p>If one (or more) of the 3 criteria applies/apply to the EEE, the contribution is increased by +20%</p>
Computer (desktop or laptop)	<p>Absence of paint and coatings incompatible with recycling and reuse on plastic parts >100g,</p> <hr/> <p><u>and</u> Incorporation of post-consumer recycled plastic (minimum threshold of 10%)</p> <hr/> <p><u>and</u> Product upgrade with standard tools, including memory drives, chips and cards</p>	<p>- 20 %</p>	<p>If the EEE <u>simultaneously</u> meets the 3 criteria, the contribution is reduced by -20%</p>

Example of criteria

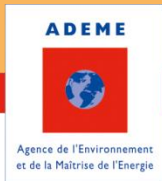

Telephone	Lack of standardised connections (charger and other connections) <hr/> <u>or</u> Lack of mutually compatible software updates, essential for the basic use of the device	+ 100 %	If one (or both) of the criteria applies/apply to the EEE, the contribution is increased by +100%
Televisions	Provision of technical documentation for electrically authorised repairers and essential parts for equipment use (electronic boards) for 5 years <hr/> <u>or</u> Incorporation of post-consumer recycled plastic (minimum threshold of 10%)	- 20 %	If the EEE meets one of the 2 criteria or both, the contribution is reduced by -20%

Impact of modulation

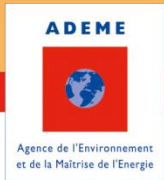

- Better eco-design of products, extension of the life time of products, better recyclability, use in the manufacturing of the equipments of recycled materials, decrease of pollutants
- Not much impact on the consumer, much more on the producer
- Measure which penalizes the low-cost products
- Favor the repair sector with not offshoring jobs



- The modulation of fees must be :
 - ➔ Implemented in all the member States
 - ➔ With the same criteria : a patchwork of different criteria in all the member states would have no impact on products conception
 - ➔ Simple to implement
 - ➔ Controllable : ensuring healthy competition between companies
 - ➔ Concern 20 % of the market : good criteria should only concern a small part of the products
 - ➔ Ensure the financial balance of the sector